

## VO Series (VRLA 5yr Life)

### Dimensions (mm)

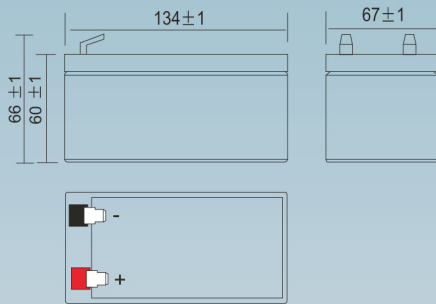

### Standard terminal (mm)

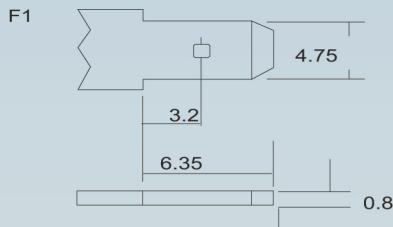

### Physical Specification

Nominal Voltage		12V
Nominal Capacity		3.4 AH
Dimension	Length	134 ± 2 mm
	Width	67 + 2 mm
	Container Height	60 ± 2 mm
	Total Height (with terminal)	66 ± 2 mm
Weight		Approx 1.34kg
Standard Terminal		F1

## PS-1230 12V 3.4AH



### Discharge Characteristics (25°C, 77°F)

Rated Capacity	20hr Rate (170mA)	3.4AH	Constant Voltage Charge	Cycle	Initial Charging Current Less than 0.85A Voltage 14.40V ~ 15.0V at 25°C (77°F)
	10hr Rate (325mA)	3.25AH			
Capacity Affected by Temperature	8hr Rate (396mA)	3.17AH	Constant Voltage Charge	Standby	Recommended Charge Current less than 0.85A Voltage 13.5V ~ 13.8V at 25°C (77°F)
	5hr Rate (585mA)	2.93AH			
	1hr Rate (2.21A)	2.21AH			
Capacity Affected by Temperature	40°C (104°F)	103%	Constant Voltage Charge	Standby	Recommended Charge Current less than 0.85A Voltage 13.5V ~ 13.8V at 25°C (77°F)
	25°C (77°F)	100%			
	0°C (32°F)	86%			

### Internal Resistances m0hms

45.0 m0hms

### Constant Current Discharge Characteristics Unit: Amperes (25°C, 77°F)

F.V/Time	5MIN	10MIN	15MIN	20MIN	30MIN	45MIN	1HR	2HR	3HR	4HR	5HR	6HR	8HR	10HR	20HR	24HR	48HR	72HR	100HR	
1.60V	13.12	8.91	6.60	5.39	3.91	2.72	2.21	1.26	0.957	0.769	0.629	0.534	0.412	0.342						
1.67V	11.32	7.96	5.99	4.95	3.63	2.58	2.11	1.21	0.911	0.731	0.599	0.517	0.405	0.335						
1.70V	10.79	7.61	5.80	4.76	3.51	2.55	2.07	1.19	0.891	0.721	0.593	0.512	0.402	0.331						
1.75V	9.80	6.98	5.44	4.53	3.37	2.45	2.00	1.14	0.867	0.702	0.585	0.502	0.396	0.328	0.172	0.148	0.078	0.054	0.039	
1.80V	8.69	6.35	4.98	4.21	3.25	2.36	1.92	1.10	0.851	0.687	0.563	0.488	0.389	0.325	0.170	0.147	0.077	0.053	0.039	
1.85V	6.47	4.97	4.12	3.56	2.75	2.03	1.71	1.01	0.791	0.643	0.525	0.455	0.367	0.307	0.168	0.144	0.076	0.052	0.038	

### Constant Power Discharge Characteristics Unit: Watts (25°C, 77°F)

F.V/Time	5MIN	10MIN	15MIN	20MIN	30MIN	45MIN	1HR	2HR	3HR	4HR	5HR	6HR	8HR	10HR	20HR	24HR	48HR	72HR	100HR	
1.60V	130.5	90.9	69.3	57.9	42.8	30.3	25.0	14.4	11.00	8.86	7.28	6.21	4.83	4.03						
1.67V	116.0	83.5	64.2	54.0	40.1	29.0	24.0	13.9	10.50	8.47	6.96	6.03	4.76	3.96						
1.70V	111.4	80.1	62.4	52.1	39.0	28.7	23.6	13.7	10.30	8.37	6.90	5.99	4.73	3.92						
1.75V	104.1	75.2	59.3	50.0	37.7	27.7	23.0	13.2	10.00	8.16	6.82	5.87	4.67	3.89	2.04	1.78	0.948	0.652	0.479	
1.80V	94.3	69.6	55.0	46.9	36.6	27.0	22.0	12.8	9.89	8.01	6.59	5.74	4.60	3.85	2.02	1.77	0.941	0.647	0.474	
1.85V	71.0	55.1	46.1	40.3	31.5	23.4	19.8	11.8	9.25	7.54	6.17	5.37	4.35	3.64	2.00	1.75	0.932	0.637	0.466	

